

\* THESE COMPONENTS ARE LOCATED IN THE STUFFING BOX GROUP, ITEM ③  
 \*\* THESE COMPONENTS ARE LOCATED IN THE FLUID CYLINDER GROUP, ITEM ②  
 \*\*\* THESE COMPONENTS ARE LOCATED IN THE POWER END, ITEM ①

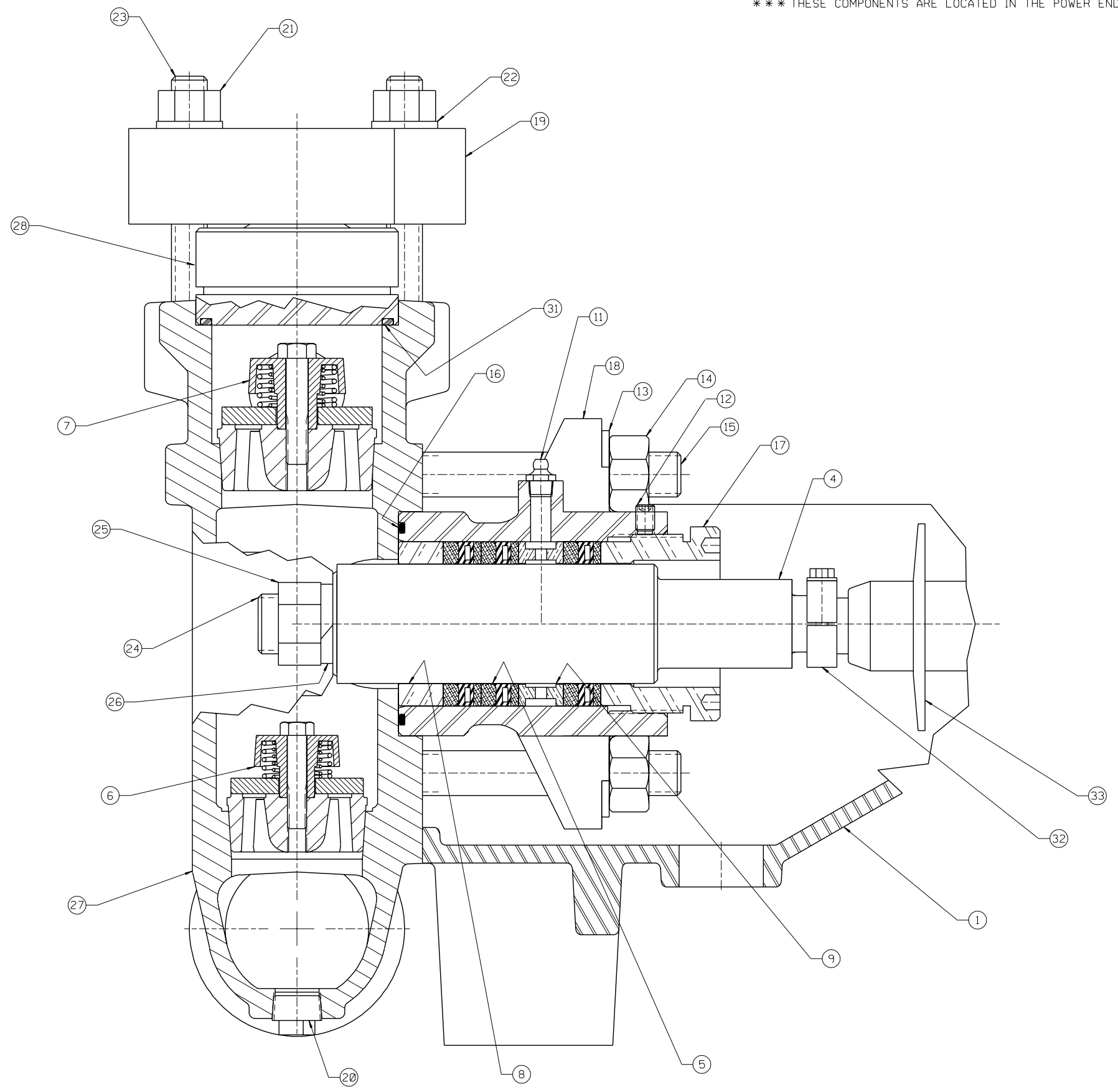

ITEM	NO. RECD	PART NO.	PART NAME
①	1	3265542	POWER END:
②	1	3265871	FLUID CYLINDER GROUP:
③	3	P502525	STUFFING BOX GROUP:
④	3	5262856	PLUNGER: 2" DIA, COLMONOY
⑤	3	5262878	PACKING SET: 2" DIA, 838
⑥	3	5277072	VALVE ASSEMBLY: SST, SUCTION
⑦	3	5277073	VALVE ASSEMBLY: SST, DISCHARGE
⑧	3	5262866	THROAT BUSHING/FOLLOWER:
⑨	3	5262870	LANTERN RING
⑩	1	5266236	LIT KIT:

* ⑪	3	1100759	LUBE FITG 1/8" STR C/Z
* ⑫	3	320320	SET SCREW 5/16-18 X 1/2 NYLON TIP
* ⑬	6	320951	FLAT WASHER: 3/4", SST
* ⑭	6	1109316	HEX NUT: 3/4"-10, SST
* ⑮	6	5262887	STUD: 3/4"-10 UNC-2A, 5.25 LG, SST
* ⑯	3	320341	O-RING: 3 3/8" OD X 1/8" NOM., BUNA-N
* ⑰	3	5262874	ADJUSTING NUT:
* ⑱	3	5262890	STUFFING BOX:
** ⑲	3	5262885	VALVE COVER CLAMP:
** ⑳	3	320071	PLUG: 3/4" NPT, SST
** ㉑	6	1109316	HEX NUT: 3/4"-10, SST
** ㉒	6	320951	FLAT WASHER: 3/4", SST
** ㉓	6	5262886	STUD: 3/4"-10 UNC-2A, 6.13 LG, SST
△ ** ㉔	2	5266592	STUD: 1-8 UNC-2A, 4.63 LG, SST
** ㉕	2	320443	HEX NUT: 1"-8, SST
** ㉖	2	320442	LOCK WASHER: 1", SST
** ㉗	1	5264119	FLUID CYLINDER:
** ㉘	3	5264371	VALVE COVER:
** ㉙	2	1177203	CAPPLUG: INT. 20S (NOT SHOWN)
** ㉚	2	1120444	CAPPLUG: INT. 501 (NOT SHOWN)
△ ** ㉛	3	A90-232	O-RING: 3" OD X 1/8" NOM, BUNA-N
** ㉜	3	1252143	CLAMP ASSEMBLY :
** ㉝	3	5262851	SHIELD DEFLECTOR:

NOTES:  
 1 TORQUE FASTENERS PER FMC ENGR SPEC AS-22  
 2 TEST PUMP AS PER FMC ENGR SPEC AS-15  
 3 STAMP NAMEPLATE PER FMC ENGR SPEC AS-21  
 4 PAINT PUMP PER FMC ENGR SPEC CP-20

This drawing is the property of FMC Corporation, and may not be used, reproduced, published, or disclosed to others, without express authorization FMC Corp.

**FMC** FMC Corporation  
 Fluid Control Division  
 2825 W. Washington Box 1377  
 Stephenville, Texas 76481

Unless Otherwise Specified:  
 Remove all burrs & sharp corners .005 R.  
 All diameters concentric unless .001 I.D.  
 Angles ±1/2°  
 .XX ±.015  
 .XXX ±.005  
 Finish 125 RMS  
 All dimensions are in inches

PUMP ASSEMBLY  
 M1216, DI, 3" NPT X 1 1/2" NPT FLUID END  
 COLMONOY PLGR, 838 PKG, DEL/SST DISC  
 VALVE ASSEMBLIES

D	REV BOM	5007118	SJK	10-19-01	RELEASED FOR PRODUCTION	ECN	DATE	03-21-84	DRAWN	BKM	07-24-97	SCALE:	NONE
C	REVISE & DIGITIZE	5000915	BKM	07-24-97	CDK.	SJK	08-19-97	SIZE	08-19-97	APPD.	RMC	08-20-97	DRAWING NO.
REV	WAS	ECN	BY	DATE	✓								5264673

5264673